

- Ball Valve •Gate Valve •Globe Valve •Check Valve •Forged Valve •DIN Valve

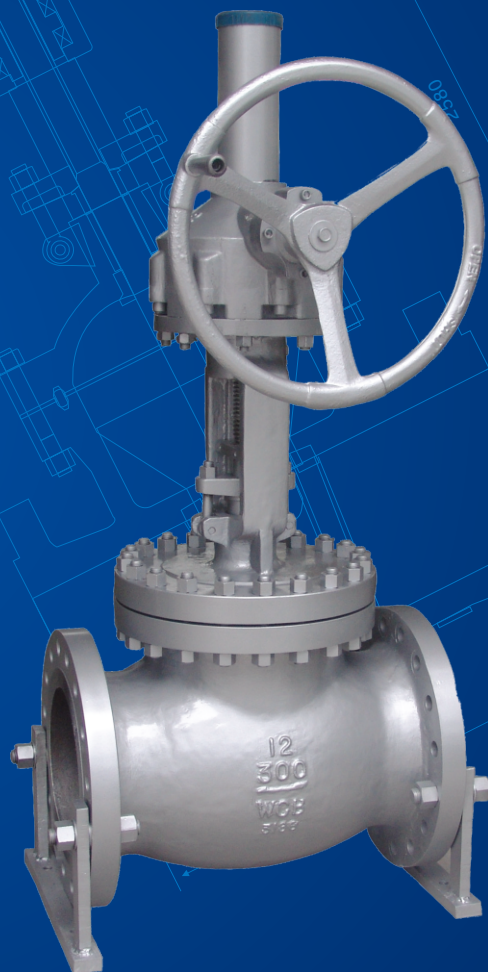
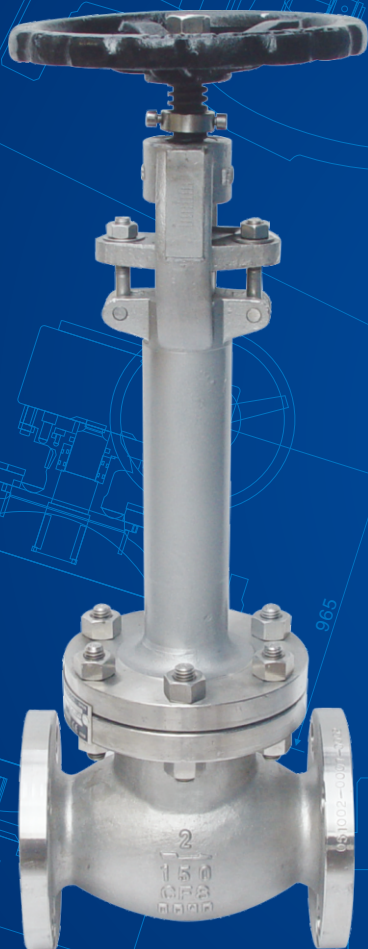

YUANDONG VALVES GROUP CO., LTD

GLOBE VALVE DATA SHEET

YODO® **LEAD**®

Cast Steel Globe Valve CL150–2500

Applicable standards:

- STEEL GLOBE VALVES BS EN 13709/API 600
- STEEL VALVES, ASME B16.34
- FACE TO FACE, ASME B16.10
- END FLANGES, ASME B16.5
- BUTTWELDING ENDS, ASME B16.25
- INSPECTION AND TEST ,API 598

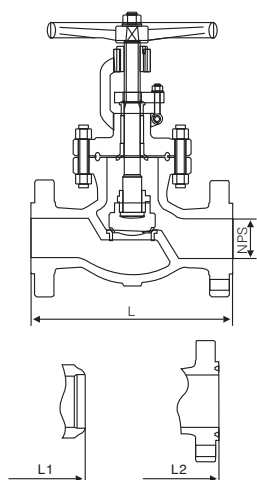

CL150

NPS	2	2½	3	4	6	8	10	12	14	16
L/L1(RF)	203	216	241	292	406	495	622	698	787	914
L2(BW)	203	216	241	292	406	495	622	698	787	914

CL300

NPS	2	2½	3	4	6	8	10	12
L/L1(RF)	267	292	318	356	444	559	622	711
L2(BW)	282	308	333	371	460	575	638	727

Applicable standards:

- STEEL GLOBE VALVES BS EN 13709/API 600
- STEEL VALVES, ASME B16.34
- FACE TO FACE, ASME B16.10
- END FLANGES, ASME B16.5
- BUTTWELDING ENDS, ASME B16.25
- INSPECTION AND TEST ,API 598

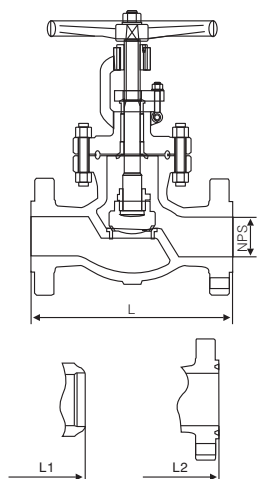

CL600

NPS	2	2½	3	4	6	8	10	12
L/L1(RF)	292	330	356	432	559	660	787	838
L2(BW)	295	333	359	435	562	663	790	841

CL 900

NPS	2	2½	3	4	6	8	10
L/L1(RF)	368	419	381	457	610	737	838
L2(BW)	371	422	384	460	613	740	841

Applicable standards:

- STEEL GLOBE VALVES BS EN 13709/API 600
- STEEL VALVES, ASME B16.34
- FACE TO FACE, ASME B16.10
- END FLANGES, ASME B16.5
- BUTTWELDING ENDS, ASME B16.25
- INSPECTION AND TEST ,API 598

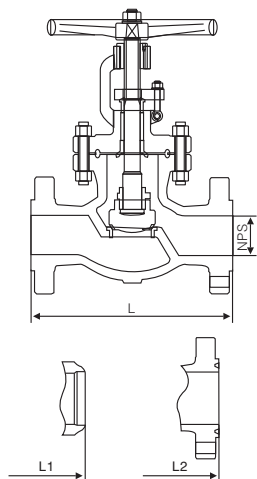

CL1500

NPS	2	2½	3	4	6	8
L/L1(RF)	368	419	470	546	705	832
L2(BW)	371	422	473	549	711	841

CL2500

NPS	2	2½	3	4	6
L/L1(RF)	451	508	578	673	914
L2(BW)	454	514	584	683	927

Pressure Seal Globe Valve CL900–2500

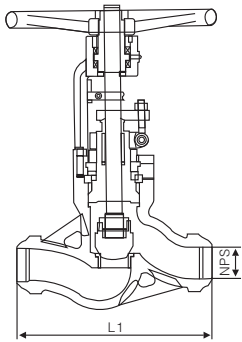

Applicable Standards:

- STEEL GLOBE VALVES, BS EN 13709/API 600
- STEEL VALVES, ASME B16.34
- FACE TO FACE, ASME B16.10
- END FLANGES ASME B16.5
- BUTTWELDING ENDS, ASME B16.25
- INSPECTION AND TEST, API 598

CL 900

NPS	2	2½	3	4	6	8	10	12
L(RF)	368	419	381	457	610	737	838	965
L1(BW)	216	254	305	356	508	660	787	914
L2(RTJ)	371	422	384	460	613	740	841	968

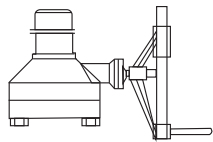

CL 1500

NPS	2	2½	3	4	6	8
L(RF)	368	419	470	546	705	832
L1(BW)	216	254	305	406	559	711
L2(RTJ)	371	422	473	549	711	842

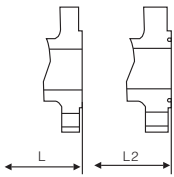

CL 2500

NPS	2	2½	3	4	6
L(RF)	451	508	578	673	914
L1(BW)	279	330	368	457	610
L2(RTJ)	454	514	584	683	927



Class Diameter	Class 150 FB	Class 300 FB	Class 600 FB	Class 900 FB	Class 1500 FB	Class 2500 FB
2"	●	●	●	●	●	●
3"	●	●	●	●	●	●
4"	●	●	●	●	●	●
6"	●	●	●	●	●	●
8"	●	●	●	●	●	●
10"	●	●	●	●	●	●
12"	●	●	●	●	●	●
14"	●	●	●	●	●	●
16"	●	●	●	●	●	●
18"	●	●	●	●	●	●
20"	●	●	●	●	●	●
22"	●	●	●	●	●	●
24"	●	●	●	●	●	●
26"	●	●	●	●	●	●

Other dimension on request

DIN Cast Steel Globe Valve PN25-160

Applicable standards:

- DESIGN AND MANUFACTURE :EN13709
- INSPECTION AND TEST:ISO5208、EN 12266
- FLANGED ENDS DIMENSIONS:EN 1092-1、DIN2544 PN25、DIN2545 PN40、DIN2546 PN64
- BUTT-WELDED ENDS DIMENSION:EN12627
- FACE TO FACE AND END TO END:DIN 3202、EN558-1、ISO5752
- PRESSURE-TEMPERATURE RATINGS:DIN 2401

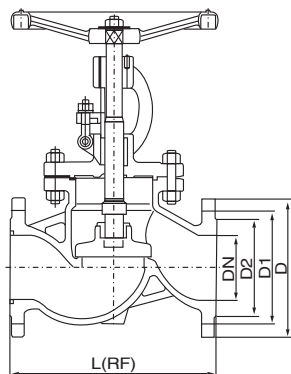

DIN F1 cast stem globe valve

PN25

DN	15	20	25	32	40	50	65	80	100	125	150	200	250	300	
L	RF	130	150	160	180	200	230	290	310	350	400	450	600	730	850
	BW	130	150	160	180	200	230	290	310	350	400	450	600	730	850
D	95	105	115	140	150	165	185	200	235	270	300	360	425	485	
D1	65	75	85	100	110	125	145	160	190	220	250	310	370	430	
D2	45	58	68	78	88	102	122	138	162	188	218	278	335	395	

PN40

DN	15	20	25	32	40	50	65	80	100	125	150	200	250	300	
L	RF	130	150	160	180	200	230	290	310	350	400	450	600	730	850
	BW	130	150	160	180	200	230	290	310	350	400	450	600	730	850
D	95	105	115	140	150	165	185	200	235	270	300	375	450	515	
D1	65	75	85	100	110	125	145	160	190	220	250	320	385	450	
D2	45	58	68	78	88	102	122	138	162	188	218	285	345	410	



DIN F2 cast stem globe valve

PN64

DN	15	20	25	32	40	50	65	80	100	125	150	200	
L	RF	210	230	230	230	260	300	340	380	430	500	550	650
	BW	210	230	230	230	260	300	340	380	430	500	550	650
D	105	130	130	140	170	180	205	215	250	295	345	415	
D1	75	90	90	100	125	135	160	170	200	240	280	345	
D2	45	52	52	68	88	102	122	138	162	188	218	285	

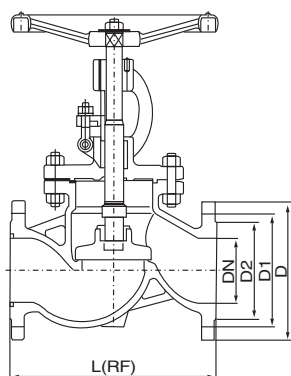

PN100

DN	40	50	65	80	100	125	150	200	
L	RF	260	300	340	380	430	500	550	650
	BW	260	300	340	380	430	500	550	650
D	170	195	220	230	265	315	355	430	
D1	125	145	170	180	210	250	290	360	
D2	88	102	122	138	162	188	218	285	

PN160

DN	40	50	65	80	100	125	150	
L	RF	260	300	340	380	430	500	550
	BW	260	300	340	380	430	500	550
D	170	195	220	230	265	315	355	
D1	125	145	170	180	210	250	290	
D2	88	102	122	138	162	188	218	



DIN Cast Steel Globe Valve PN25-160

Applicable standards:

- DESIGN AND MANUFACTURE :EN13709
- INSPECTION AND TEST:ISO5208、EN 12266
- FLANGED ENDS DIMENSIONS:EN 1092-1、DIN2544 PN25、DIN2545 PN40、DIN2546 PN64
- BUTT-WELDED ENDS DIMESNION:EN12627
- FACE TO FACE AND END TO END:DIN 3202、EN558-1、ISO5752
- PRESSURE-TEMPERATURE RATINGS:DIN 2401

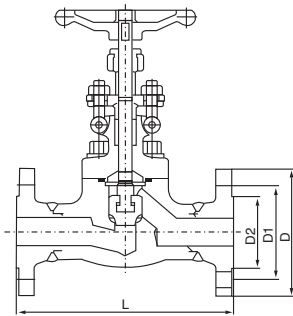

DIN Forged steel globe valve

PN25

DN	15	20	25	32	40	50
L	130	150	160	180	200	230
D	95	105	115	140	150	165
D1	65	75	85	100	110	125
D2	45	58	68	78	88	102

PN40

DN	15	20	25	32	40	50
L	130	150	160	180	200	230
D	95	105	115	140	150	165
D1	65	75	85	100	110	125
D2	45	58	68	78	88	102

PN64

DN	15	20	25	32	40	50
L	210	230	230	260	260	300
D	105	130	140	155	170	180
D1	75	90	100	110	125	135
D2	45	52	68	75	88	102

Applicable standards:

- DESIGN AND MANUFACTURE :EN13709
- INSPECTION AND TEST:ISO5208、EN 12266
- FLANGED ENDS DIMENSIONS:EN 1092-1、DIN2544 PN25、DIN2545 PN40、DIN2546 PN64
- BUTT-WELDED ENDS DIMESNION:EN12627
- FACE TO FACE AND END TO END:DIN 3202、EN558-1、ISO5752
- PRESSURE-TEMPERATURE RATINGS:DIN 2401

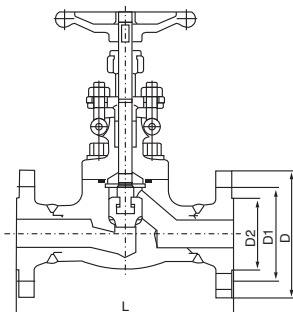

PN100

DN	15	20	25	32	40	50
L	210	230	230	260	260	300
D	105	130	140	155	170	195
D1	75	90	100	110	125	145
D2	45	52	68	75	88	102

PN160

DN	15	20	25	32	40	50
L	210	230	230	260	260	300
D	105	130	140	155	170	195
D1	75	90	100	110	125	145
D2	45	52	68	75	88	102

Female Threaded and Socket Welded Globe Valve CL800-1500

Applicable standards:

- Design and manufacture conform to :BS5352、MSS-SP-118
- Connection ends conform to :
 - 1)Socket welded dimension conform ANSI B16.11
 - 2)Screw ends dimension conform to ANSI B1.20.1
 - 3)Butt-welded conform to ANSI B16.25
 - 4)Flanged ends conform to ANSI B16.5
- Test and inspection conform to :API 598
- Structure features:
 - Bolted bonnet,outside screw and yoke
 - Welded bonnet,outside screw and yoke
- Materials conform to ANSI/ASTM
- Main materials:A105;LF2;F5;F11;F22;304(L);316(L);F347;F321;F51;Monel;20 Alloy.

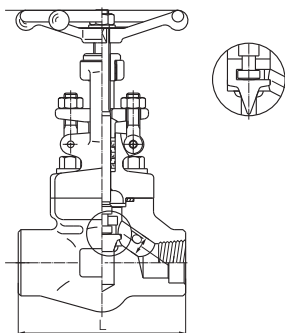

CL800

Bolted bonnet,full port & reducing port outside screw and yoke(OS & Y) threaded,butt-welded or socket welded ends;design to BS5352

NPS	R.P	-	1/2	3/4	1	1 1/4	1 1/2	2	2 1/2	3
	F.P	1/4	3/8	1/2	3/4	1	1 1/4	1 1/2	2	2 1/2
L		79	79	92	111	120	152	172	200	-
D		7	9	13	17.5	23	30	35	46	-

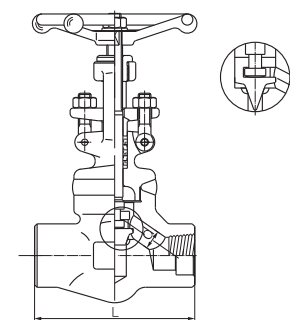

CL800

Welded bonnet,full port & reducing port outside screw and yoke(OS & Y) threaded,butt-welded or socket welded ends;design to BS5352

NPS	R.P	-	1/2	3/4	1	1 1/4	1 1/2	2	2 1/2	3
	F.P	1/4	3/8	1/2	3/4	1	1 1/4	1 1/2	2	2 1/2
L		79	79	92	111	120	152	172	200	-
D		7	9	13	17.5	23	30	35	46	-

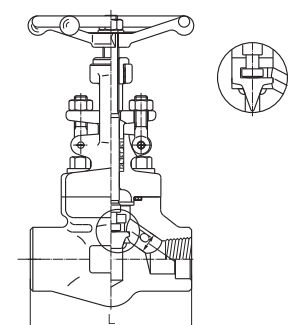

CL900-CL1500

Bolted bonnet,full port & reducing port outside screw and yoke(OS & Y) threaded,butt-welded or socket welded ends;design to BS5352

NPS	R.P	-	1/2	3/8	1	1 1/4	1 1/2	2	2 1/2	3
	F.P	1/4	3/8	1/2	3/4	1	1 1/4	1 1/2	2	2 1/2
L		92	111	111	120	152	172	200	220	-
D		7	12	15	20	28	32	40	45	-

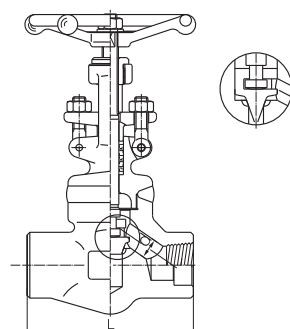

CL900-CL1500

Welded bonnet,full port & reducing port outside screw and yoke(OS & Y) threaded,butt-welded or socket welded ends;design to BS5352

NPS	R.P	-	1/2	3/8	1	1 1/4	1 1/2	2	2 1/2	3
	F.P	1/4	3/8	1/2	3/4	1	1 1/4	1 1/2	2	2 1/2
L		92	111	111	120	152	172	200	220	-
D		-	12	15	20	28	32	40	45	-

Female Threaded and Socket Welded Globe Valve CL900–2500

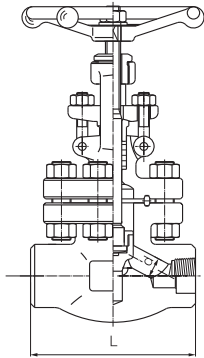

CL900–CL1500

Bolted bonnet, full port outside screw and yoke (OS & Y) threaded, butt-welded or socket welded ends; design to BS5352

NPS		1/2	3/4	1	1 1/4	2	2 1/2
F.P	L	110	110	150	150	210	235
	D	9	12	15	20	32	40

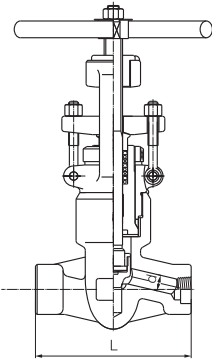

CL900–CL1500

Pressure seal bonnet, full port outside screw and yoke (OS & Y) threaded, butt-welded or socket welded ends; design to BS5352

NPS		1/2	3/4	1	1 1/4	1 1/2	2	2 1/2
F.P	L	110	110	110	178	178	210	–
	D	12	15	20	28	32	40	–

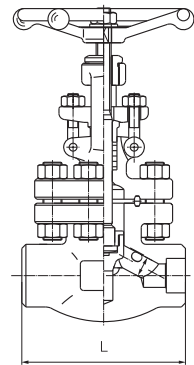

CL2500

Bolted bonnet, full port outside screw and yoke (OS & Y) Socket welded ends; design conform to ASME B16.34

NPS		1/2	3/4	1	1 1/4	1 1/2	2	2 1/2
F.P	L	150	150	210	–	235	235	–
	D	11	14	19	–	28	35	–

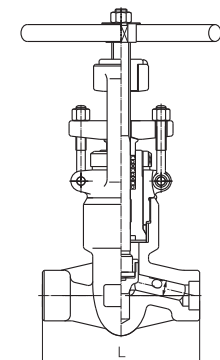

CL2500

Pressure seal bonnet, full port outside screw and yoke (OS & Y) socket welded ends; design conform to ASME B16.34

NPS		1/2	3/4	1	1 1/4	1 1/2	2	2 1/2
F.P	L	186	186	186	232	232	279	–
	D	11	14	19	25	28	35	–

Flange and Butt-Welded Globe Valve CL150-2500

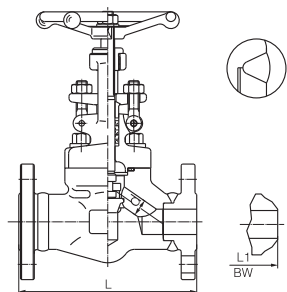

CL150-300-600

Bolted bonnet, reducing port outside screw and yoke (OS & Y)
Flange or butt-welding design to BS5352

NPS	F.P	1/4	3/8	1/2	3/4	1	1 1/4	1 1/2	2
L(RF) L1(BW)		-	-	108	117	127	140	165	203
		-	-	152	178	203	216	229	267
		-	-	165	190	216	229	241	292
D		-	-	9	13	17.5	23	30	35

Flange Integrity forged steel valve enquiry please contact sales department.

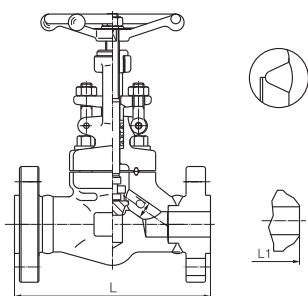

CL900-CL1500

Bolted bonnet, full port outside screw and yoke (OS & Y)
Flange or butt-welding design to BS5352

(NPS)	F.P	1/4	3/8	1/2	3/4	1	1 1/4	1 1/2	2
L(RF), L1(BW)		-	-	216	229	254	279	305	368
L(RTJ)		-	-	216	229	254	279	305	371
D		-	-	12	15	20	28	32	40

Flange Integrity forged steel valve enquiry please contact sales department.

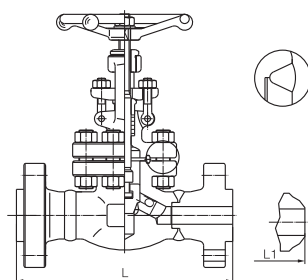

CL2500

Bolted bonnet, full port outside screw and yoke (OS & Y)
Flange or butt-welded design conform to ASME B16.34

(NPS)	F.P	1/4	3/8	1/2	3/4	1	1 1/4	1 1/2	2
L(RF), L1(BW)		-	-	264	273	308	-	384	451
L(RTJ)		-	-	264	273	308	-	387	454
D		-	-	11	14	19	-	28	35

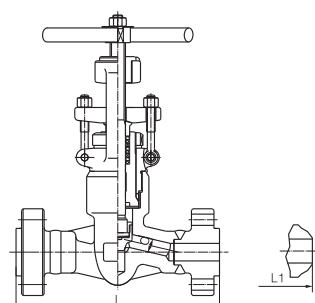

CL2500

Pressure seal bonnet, full port outside screw and yoke (OS & Y)
Flange or butt-welded design conform to ASME B16.34

(NPS)	F.P	1/4	3/8	1/2	3/4	1	1 1/4	1 1/2	2
L(RF), L1(BW)		-	-	264	273	308	349	384	451
L(RTJ)		-	-	264	273	308	349	387	454
D		-	-	11	14	19	25	28	35

Short Pattern Bellow Seal Globe Valve CL800

Applicable standards:

- Design and manufacture conform to :BS5352; MSS-SP-117
- Connection ends conform to :
 - 1)Socket welded dimension conform ANSI B16.11
 - 2)Screw ends dimension conform to ANSI B1.20.1
 - 3)Butt-welded conform to ANSI B16.25
 - 4)Flanged ends conform to ANSI B16.5
- Test and inspection conform to :API 598
- Structure features:
 - Bolted bonnet,outside screw and yoke
 - Welded bonnet,outside screw and yoke
- Materials conform to ANSI/ASTM
- Main materials:A105;LF2;F5;F11;F22;304(L);316(L); F347;F321;F51;Monel;20 Alloy.
- Bellow materials:304,321,316,Inconel 625,hastelloy,C 276,Monel

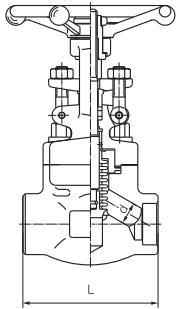

CL800

Bolted bonnet,full port & reducing port outside screw and yoke(OS & Y)
Threaded,butt-welded or socket welded ends;design to BS5352/MSS-SP-117

NPS	R.P	-	1/2	3/4	1	1 1/4	1 1/2	2	2 1/2
	F.P	1/4	3/8	1/2	3/4	1	1 1/4	1 1/2	2
L		79	79	92	111	120	152	170	200
D		7.0	9.0	13	17.5	23	30	35	46

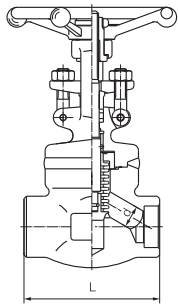

CL800

Welded bonnet,full port & reducing port outside screw and yoke(OS & Y)
Threaded,butt-welded or socket welded ends;design to BS5352、MSS-SP-117

NPS	R.P	-	1/2	3/4	1	1 1/4	1 1/2	2	2 1/2
	F.P	1/4	3/8	1/2	3/4	1	1 1/4	1 1/2	2
L		79	79	92	111	120	152	170	200
D		7.0	9.0	13	17.5	23	30	35	46

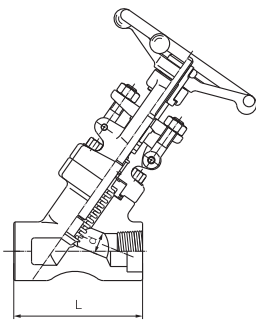

CL800

Bolted bonnet,full port & reducing port outside screw and yoke(OS & Y)
Threaded,butt-welded or socket welded ends;design to BS5352、MSS-SP-117

NPS	R.P	-	1/2	3/4	1	1 1/4	1 1/2	2	2 1/2
	F.P	1/4	3/8	1/2	3/4	1	1 1/4	1 1/2	2
L		98	98	98	111	140	140	155	170
D		7	9	13	17.5	23	30	35	46

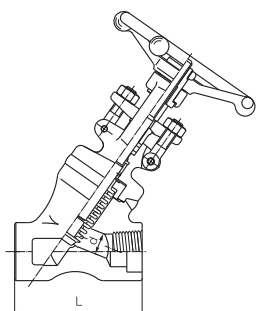

CL800

Welded bonnet,full port & reducing port outside screw and yoke(OS & Y)
Threaded,butt-welded or socket welded ends;design to BS5352、MSS-SP-117

NPS	R.P	-	1/2	3/4	1	1 1/4	1 1/2	2	2 1/2
	F.P	1/4	3/8	1/2	3/4	1	1 1/4	1 1/2	2
L		79	79	92	100	140	140	155	170
D		7	9	13	17.5	23	30	35	46

Bellow Sealed Globe Valve CL800–1500

Applicable standards:

- Design and manufacture conform to :API602、MSS-SP-117
- Connection ends conform to :
 - 1)Socket welded dimension conform ANSI B16.11
 - 2)Screw ends dimension conform to ANSI B1.20.1
 - 3)Butt-welded conform to ANSI B16.25
 - 4)Flanged ends conform to ANSI B16.5
- Test and inspection conform to :API 598
- Structure features:
 - Bolted bonnet,outside screw and yoke
 - Welded bonnet,outside screw and yoke
- Materials conform to ANSI/ASTM
- Main materials:A105;304(L);316(L);F347;F321
- Bellow materials:304、321、316、Inconel 625,hastelloy,C 276,Monel

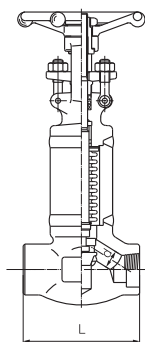

CL800

Welded bonnet,full port & reducing port outside screw and yoke(OS & Y)
Threaded,butt-welded or socket welded ends;design to BS5352/MSS-SP-117

NPS	R.P	-	1/2	3/4	1	1 1/4	1 1/2	2	2 1/2
	F.P	1/4	3/8	1/2	3/4	1	1 1/4	1 1/2	2
L		79	79	92	111	120	152	172	200
D		7.0	9.0	13	17.5	23	30	35	46

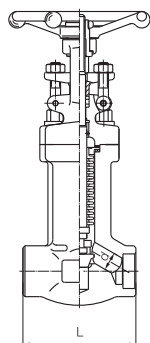

CL800

Bolted bonnet,full port & reducing port outside screw and yoke(OS & Y)
Threaded,butt-welded or socket welded ends;design to BS5352/MSS-SP-117

NPS	R.P	-	1/2	3/4	1	1 1/4	1 1/2	2	2 1/2
	F.P	1/4	3/8	1/2	3/4	1	1 1/4	1 1/2	2
L		79	79	92	111	120	152	172	200
D		7.0	9.0	13	17.5	23	30	35	46

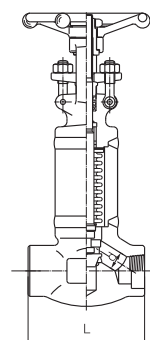

CL1500

Welded bonnet,full port & reducing port outside screw and yoke(OS & Y)
Threaded,butt-welded or socket welded ends;design to BS5352/MSS-SP-117

NPS	F.P	1/4	3/8	1/2	3/4	1	1 1/4	1 1/2	2
L		92	92	111	111	120	152	172	200
D		7	9	12	15	20	28	32	40

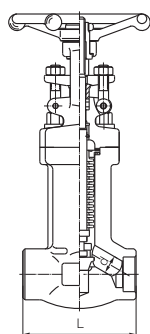

CL1500

Bolted bonnet,full port outside screw and yoke(OS & Y)
Threaded,butt-welded or socket welded ends;design to BS5352/MSS-SP-117

NPS	F.P	1/4	3/8	1/2	3/4	1	1 1/4	1 1/2	2
L		92	92	111	111	120	152	172	200
D		7	9	12	15	20	28	32	40

Bellow Sealed Globe Valve CL150-1500

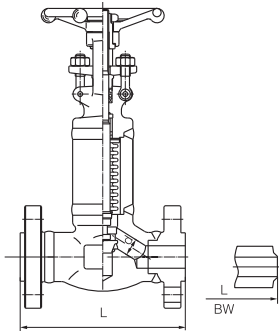

CL150-300-600

Welded bonnet, reducing port outside screw and yoke (OS & Y)
Flange-or butt-welded ends; design to BS5352/MSS-SP-117

NPS	R.P	1/4	3/8	1/2	3/4	1	1 1/4	1 1/2	2
L(RF) L1(BW)		-	-	108	117	127	140	165	203
		-	-	152	178	203	216	229	267
		-	-	165	190	216	229	241	292
D		-	-	9	13	17.5	23	30	35

Flange Integrity forged steel valve enquiry please contact sales department.

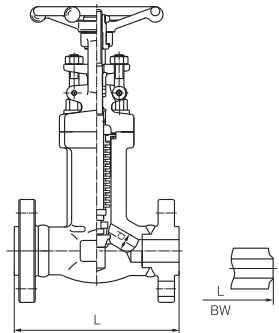

CL150-300-600

Bolted bonnet, reducing port outside screw and yoke (OS & Y)
Flange-or butt-welded ends; design to BS5352/MSS-SP-117

NPS	R.P	1/4	3/8	1/2	3/4	1	1 1/4	1 1/2	2
L(RF) L1(BW)		-	-	108	117	127	140	165	203
		-	-	152	178	203	216	229	267
		-	-	165	190	216	229	241	292
D		-	-	9	13	17.5	23	30	35

Flange Integrity forged steel valve enquiry please contact sales department.

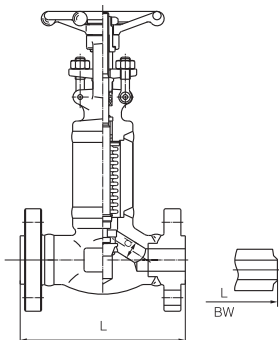

CL1500

Welded bonnet, full port outside screw and yoke (OS & Y)
Flange-or butt-welded ends; design to BS5352/MSS-SP-117

NPS	F.P	1/4	3/8	1/2	3/4	1	1 1/4	1 1/2	2
L		-	-	216	229	254	280	305	368
D		-	-	12	15	20	28	32	40

Flange Integrity forged steel valve enquiry please contact sales department.

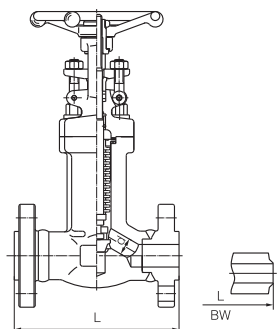

CL1500

Bolted bonnet, full port outside screw and yoke (OS & Y)
Flange-or butt-welded ends; design to BS5352/MSS-SP-117

NPS	F.P	1/4	3/8	1/2	3/4	1	1 1/4	1 1/2	2
L(RF), L1(BW)		-	-	216	229	254	280	305	368
L(RTJ)		-	-	216	229	254	280	305	371
D		-	-	12	15	20	28	32	40

Flange Integrity forged steel valve enquiry please contact sales department.

Y Type Globe Valve CL800-1500

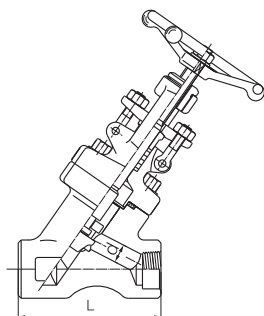

CL800

Bolted bonnet, full port & reducing port outside screw and yoke (OS & Y) threaded, butt-welded or socket welded ends; design to BS5352

NPS	R.P	-	1/2	3/4	1	1 1/4	1 1/2	2	2 1/2	3
	F.P	1/4	3/8	1/2	3/4	1	1 1/4	1 1/2	2	2 1/2
L		98	98	98	111	140	140	155	170	-
D		7	9	13	17.5	23	30	35	46	-

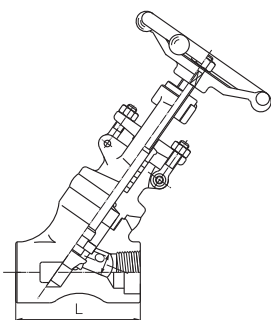

CL800

Welded bonnet, full port & reducing port outside screw and yoke (OS & Y) threaded, butt-welded or socket welded ends; design to BS5352

NPS	R.P	-	1/2	3/4	1	1 1/4	1 1/2	2	2 1/2	3
	F.P	1/4	3/8	1/2	3/4	1	1 1/4	1 1/2	2	2 1/2
L		79	79	92	100	140	140	155	170	
D		7	9	13	17.5	23	30	35	46	

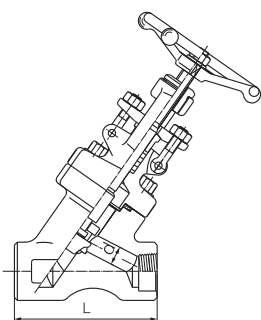

CL900-CL1500

Bolted bonnet, full port & outside screw and yoke (OS & Y) threaded, butt-welded or socket welded ends; design to BS5352

NPS	F.P	3/8	1/2	3/4	1	1 1/4	1 1/2	2	2 1/2
L		98	111	111	140	140	155	170	
D		9	12	15	20	28	32	40	

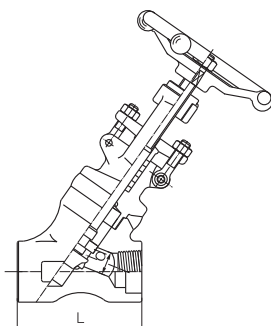

CL900-CL1500

Welded bonnet, full port & outside screw and yoke (OS & Y) threaded, butt-welded or socket welded ends; design to BS5352

NPS	F.P	3/8	1/2	3/4	1	1 1/4	1 1/2	2	2 1/2
L		92	100	100	140	140	155	170	
D		9	12	15	20	28	32	40	

Y Type Globe Valve CL2500-4500

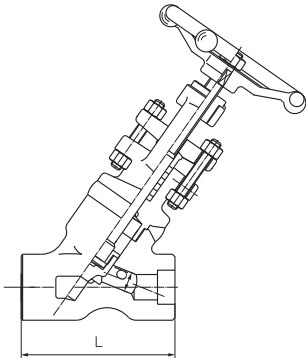

CL2500

Welded bonnet, full port outside screw and yoke (OS & Y)
Socket welded, design conform to ASME16.34

NPS	F.P	3/8	1/2	3/4	1	1 1/4	1 1/2	2	2 1/2
L		186	186	186	186	232	232	310	
D		9	11	14	19	25	28	35	

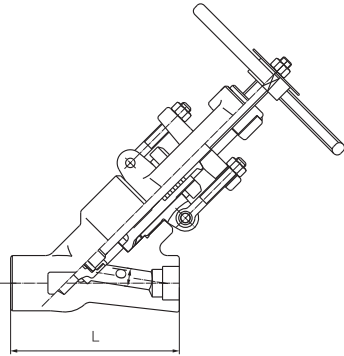

CL2500

Pressure seal bonnet, full port outside screw and yoke (OS & Y)
Socket welded, design conform to ASME16.34

NPS	F.P	3/8	1/2	3/4	1	1 1/4	1 1/2	2	2 1/2
L		186	186	186	186	232	232	310	
D		9	11	14	19	25	28	35	

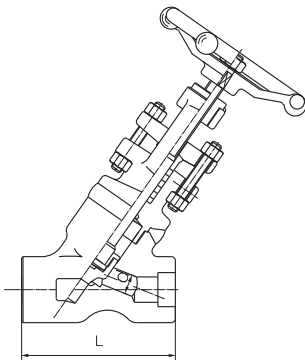

CL4500

Welded seal bonnet, full port outside screw and yoke (OS & Y)
Socket welded, design conform to ASME16.34

NPS	F.P	3/8	1/2	3/4	1	1 1/4	1 1/2	2	2 1/2
L		155	155	155	155		225	225	
D		9	11	11	15		26	28	

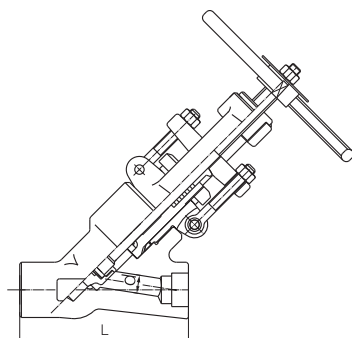

CL4500

Pressure seal bonnet, full port outside screw and yoke (OS & Y)
Socket welded, design conform to ASME16.34

NPS	F.P	3/8	1/2	3/4	1	1 1/4	1 1/2	2	2 1/2
L		200	200	200	200	250	250	330	
D		9	11	11	15	20	26	28	

Cryogenic Globe Valve CL800–1500

Applicable standards:

- Design and manufacture conform to :API 602 Bs5352 ANSI B16.34
- Connection ends conform to :
 - 1)Socket welded dimension conform ANSI B16.11
 - 2)Screw ends dimension conform to ANSI B1.20.1
 - 3)Butt-welded conform to ANSI B16.25
 - 4)Flanged ends conform to ANSI B16.5

- Test and inspection conform to :API 598
- Structure features:
 - Bolted bonnet;outside screw and yoke
 - welded bonnet,outside screw and yoke
- Materials conform to ANSI/ASTM
- Main materials:LF2;LF3;304(L);316(L);F347; F321;F51;Monel;20 Alloy.

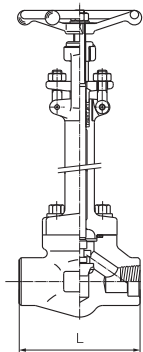

CL800

Bolted bonnet cryogenic extended bonnet full port & reduced port,(OS & Y)
Threaded or socket welded ends;design to Bs5352

NPS	R.P	-	1/2	3/4	1	1 1/4	1 1/2	2	2 1/2
	F.P	1/4	3/8	1/2	3/4	1	1 1/4	1 1/2	2
L		79	79	92	111	120	152	170	200
D		7.0	9.0	13	17.5	23	30	35	46

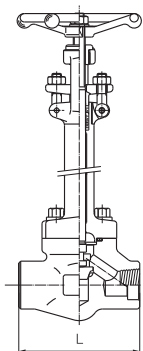

CL1500

Bolted bonnet cryogenic extended bonnet full port & reduced port,(OS & Y)
Threaded or socket welded ends;design to BS5352

NPS	R.P	-	1/2	3/4	1	1 1/4	1 1/2	2	2 1/2
	F.P	1/4	3/8	1/2	3/4	1	1 1/4	1 1/2	2
L		92	111	111	120	152	172	200	
D		9	12	15	20	28	32	40	

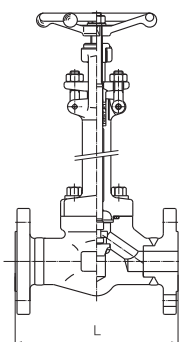

CL150–300–600

Bolted bonnet cryogenic extended bonnet ,reduced port,(OS & Y)
Flanged or butt welded ends;design to BS5352

NPS	R.P	1/4	3/8	1/2	3/4	1	1 1/4	1 1/2	2
L(RF) L1(BW)		-	-	108	118	127	-	165	203
		-	-	153	178	203	-	229	267
		-	-	165	191	216	-	241	292
D		-	-	9.0	13	17.5	-	30	35

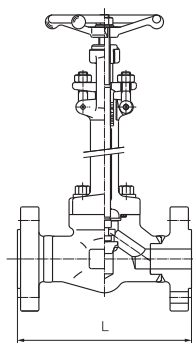

CL1500

Bolted bonnet cryogenic extended bonnet ,full port,(OS & Y)
Flanged or butt welded ends;design to BS5352

NPS	F.P	1/4	3/8	1/2	3/4	1	1 1/4	1 1/2	2
L		-	-	216	229	254	280	305	366
D		-	-	12	15	20	28	32	40

Flange Integrity forged steel valve enquiry please contact sales department.