

- Ball Valve
- Gate Valve
- Globe Valve
- Check Valve
- Forged Valve
- DIN Valve

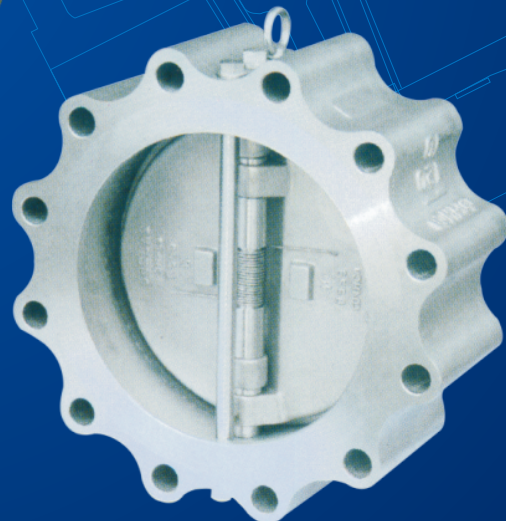

YUANDONG VALVES GROUP CO., LTD

CHECK VALVE DATA SHEET

YODO® **LEAD**®

Cast Steel Check Valve CL150–2500

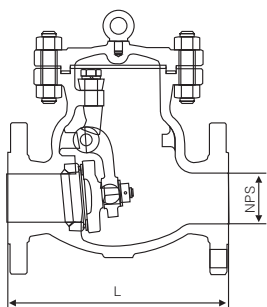

Applicable Standards:

- STEEL CHECK VALVES, API 6D
- STEEL CHECK VALVES, ISO14313
- STEEL VALVES, ASME B16.34
- FACE TO FACE, ASME B16.10
- END FLANGES, ASME B16.5
- BUTTWELDING ENDS, ASME B16.25
- INSPECTION AND TEST, API 598/API 6D

CL150

NPS	2	2½	3	4	6	8	10	12	14	16	18	20	24	26	28	30	36
L/L1(RF/BW)	203	216	241	292	356	495	622	699	787	864	978	978	1295	1295	1448	1524	1956
L2(RTJ)	216	229	254	305	368	508	635	711	800	876	991	991	1308				

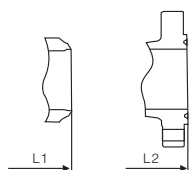

CL300

NPS	2	2½	3	4	6	8	10	12	14	16	18	20	24	26	28	30	36
L/L1(RF/BW)	267	292	318	356	445	533	622	711	838	864	978	1016	1346	1346	1499	1594	2083
L2(RTJ)	283	308	333	371	460	549	638	727	854	879	994	1035	1368	1372	1524	1619	

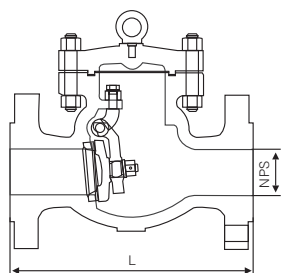

Applicable Standards:

- STEEL CHECK VALVES, API 6D
- STEEL CHECK VALVES, ISO14313
- STEEL VALVES, ASME B16.34
- FACE TO FACE, ASME B16.10
- END FLANGES, ASME B16.5
- BUTTWELDING ENDS, ASME B16.25
- INSPECTION AND TEST, API 598/API 6D

CL600

NPS	2	2½	3	4	6	8	10	12	14	16	18	20	24
L/L1(RF/BW)	292	330	356	432	559	660	787	838	889	991	1092	1194	1397
L2(RTJ)	295	333	359	435	562	664	791	841	892	994	1095	1200	1407

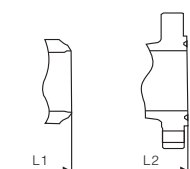

CL900

NPS	2	2½	3	4	6	8	10	12	14	16	18	20
L/L1(RF/BW)	368	419	381	457	610	737	838	965	1029	1130	1219	1321
L2(RTJ)	371	422	384	460	613	740	841	968	1038	1140	1232	1334

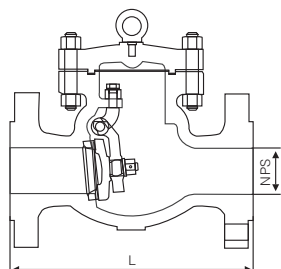

Applicable Standards:

- STEEL CHECK VALVES, API 6D
- STEEL CHECK VALVES, ISO14313
- STEEL VALVES, ASME B16.34
- FACE TO FACE, ASME B16.10
- END FLANGES, ASME B16.5
- BUTTWELDING ENDS, ASME B16.25
- INSPECTION AND TEST, API 598/API 6D

CL1500

NPS	2	2½	3	4	6	8	10	12	14	16
L/L1(RF/BW)	368	419	470	546	705	832	991	1130	1257	1384
L2(RTJ)	371	422	473	549	711	841	1000	1146	1276	1407

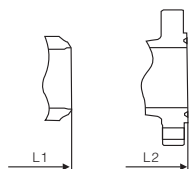

CL 2500

NPS	2	2½	3	4	6	8	10	12
L/L1(RF/BW)	451	508	578	673	914	1022	1270	1422
L2(RTJ)	454	514	584	683	927	1038	1292	1445

Pressure Seal Check Valve CL900–2500

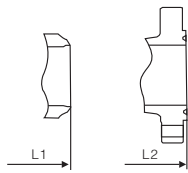
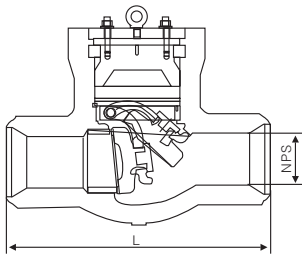

Applicable Standards:

- STEEL CHECK VALVES, API 594/API 6D
- STEEL CHECK VALVES, ISO14313
- STEEL VALVES, ASME B16.34
- FACE TO FACE, ASME B16.10
- END FLANGES, ASME B16.5
- INSPECTION AND TEST, API 598/API 6D

CL900

NPS	2	2½	3	4	6	8	10	12	14	16
L1(BW)	216	254	305	356	508	660	787	914	991	1092
L(RF)	368	419	381	457	610	737	838	965	1029	1130
L2(RTJ)	371	422	384	460	613	740	841	968	1038	1140

CL1500

NPS	2	2½	3	4	6	8	10	12	14
L1(BW)	216	254	305	406	559	711	864	991	1067
L(RF)	368	419	470	546	705	832	991	1130	1257
L2(RTJ)	371	422	473	549	711	842	1000	1146	1276

CL2500

NPS	2	2½	3	4	6	8	10	12
L1(BW)	279	330	368	457	610	762	914	1041
L(RF)	451	508	578	673	914	1022	1270	1422
L2(RTJ)	454	514	584	683	927	1038	1292	1445



Class Diameter	Class 150 RB - FB	Class 300 RB - FB	Class 600 RB - FB	Class 900 RB - FB	Class 1500 RB - FB	Class 2500 RB - FB
2"	●	●	●	●	●	●
3"	●	●	●	●	●	●
4"	●	●	●	●	●	●
6"	●	●	●	●	●	●
8"	●	●	●	●	●	●
10"	●	●	●	●	●	●
12"	●	●	●	●	●	●
14"	●	●	●	●	●	●
16"	●	●	●	●	●	●
18"	●	●	●	●	●	●
20"	●	●	●	●	●	●
22"	●	●	●	●	●	●
24"	●	●	●	●	●	●
26"	●	●	●	●	●	●
28"	●	●	●	●	●	●
30"	●	●	●	●	●	●
32"	●	●	●	●	●	●
34"	●	●	●	●	●	●
36"	●	●	●	●	●	●
38"	●	●	●	●	●	●
40"	●	●	●	●	●	●
42"	●	●	●	●	●	●
48"	●	●	●	●	●	●

Other dimension on request

Female Threaded and Socket Welded Check Valve CL800–1500

Applicable standards:

- Design and manufacture conform to :BS5352、MSS–SP–118
- Connection ends conform to :
 - 1)Socket welded dimension conform ANSI B16.11
 - 2)Screw ends dimension conform to ANSI B1.20.1
 - 3)Butt-welded conform to ANSI B16.25
 - 4)Flanged ends conform to ANSI B16.5
- Test and inspection conform to :API 598
- Structure features:
 - Gasket for bonnet connect acoptmetal ring;
 - bolt bonnet,welded bonnet
- Maaterials conform to ANSI/ASTM
- Main materials:A105;LF2;F5;F11;F22;304(L);316(L);F347

CL800

Bolted bonnet,full port and reducing port
Threaded,butt-welded or socket welded ends;design to BS5352

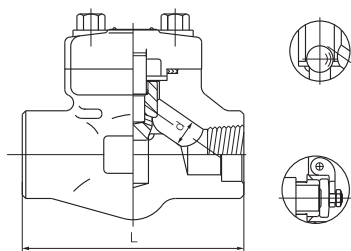

NPS	R.P	-	1/2	3/4	1	1 1/4	1 1/2	2	
	F.P	1/4	3/8	1/2	3/4	1	1 1/4	1 1/2	2
L	Lift	79	79	92	120	120	152	172	200
	swing	79	79	92	120	120	120	140	178
D	Lift	7	9	13	23	24	30	35	46
	swing	8	10.5	13.5	24	4.2	29	36.5	45

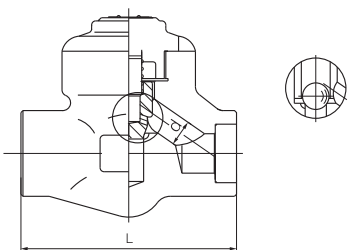

CL800

Welded bonnet,full port and reducing port
Threaded,butt-welded or socket welded ends;design to BS5352

NPS	R.P	-	1/2	3/4	1	1 1/4	1 1/2	2	2 1/2
	F.P	1/4	3/8	1/2	3/4	1	1 1/4	1 1/2	2
L		79	79	92	111	120	152	172	200
D		7	9	13	17.5	23	30	35	46

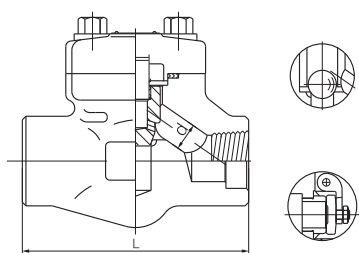

CL900–CL1500

Bolted bonnet,full port and reducing port
Threaded,butt-welded or socket welded ends;design to BS5352

NPS	R.P	-	1/2	3/4	1	1 1/4	1 1/2	2	
	F.P	1/4	3/8	1/2	3/4	1	1 1/4	1 1/2	2
L	Lift	92	111	111	120	152	172	200	-
	swing	92	111	111	120	120	140	178	-
D	Lift	7	12	15	20	23	32	40	-
	swing	8	10.5	13.5	18	24	29	45	-

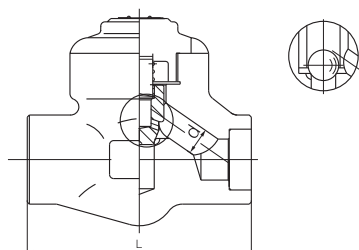

CL900–CL1500

Welded bonnet,full port and reducing port
Threaded,butt-welded or socket welded ends;design to BS5352

NPS	R.P	-	1/2	3/4	1	1 1/4	1 1/2	2	
	F.P	1/4	3/8	1/2	3/4	1	1 1/4	1 1/2	2
L		92	111	111	120	152	172	200	
D		7	12	15	20	28	32	40	

Female Threaded and Socket Welded Check Valve CL900–2500

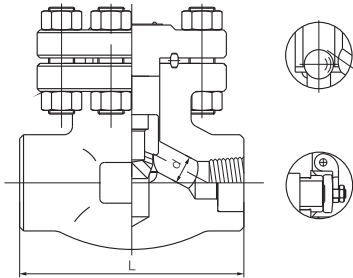

CL900–CL1500

Bolted bonnet, full port and reducing port
Threaded, butt-welded or socket welded ends; design to BS5352

NPS	F.P	1/4	3/8	1/2	3/4	1	1 1/4	1 1/2	2
L		110	110	110	110	150	150	210	235
D	Lift	9	10	12	15	20	28	32	40
	swing	8	10.5	13.5	18	24	29	36.5	45

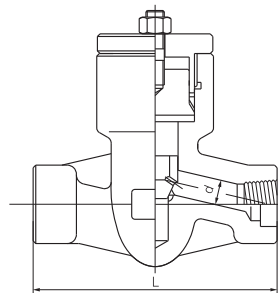

CL900–CL1500

Pressure seal bonnet, full port and reducing port
Threaded, butt-welded or socket welded ends; design to BS5352

NPS	R.P	-	1/2	3/4	1	1 1/4	1 1/2	2	2 1/2
	F.P	1/4	3/8	1/2	3/4	1	1 1/4	1 1/2	2
L			140	140	140	178	216	216	-
D			12	15	20	28	32	40	-

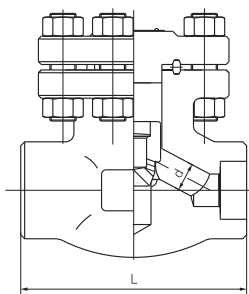

CL2500

Bolted bonnet, full port
Threaded, butt-welded or socket welded ends; design to ASME B16.34

NPS	F.P	1/4	3/8	1/2	3/4	1	1 1/4	1 1/2	2
L		150	150	150	150	210	235	235	235
D		7.5	10.5	11	14	19	25	28	35

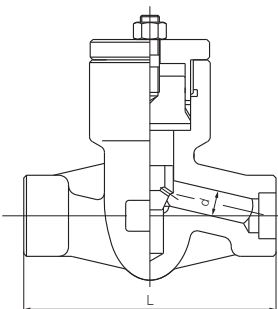

CL2500

Pressure seal bonnet, full port
Threaded, butt-welded or socket welded ends; design to ASME B16.34

NPS	F.P	1/4	3/8	1/2	3/4	1	1 1/4	1 1/2	2
L		-	-	186	186	186	232	232	279
D		-	-	11	14	19	25	28	35

Flange and Butt-Welded Check Valve CL150-600

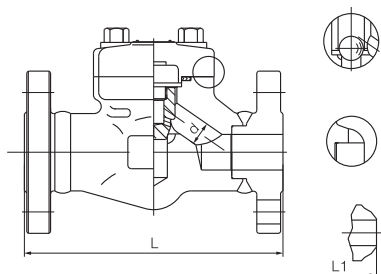

CL150-300-600

Bolted bonnet, reducing port
Flange- or butt-welded ends; design to Bs5352

(NPS)	R.P	1/4	3/8	1/2	3/4	1	1 1/4	1 1/2	2
L(RF) L1(BW)	-	-	-	108	118	127	140	165	203
	-	-	-	153	178	203	216	229	267
	-	-	-	165	191	216	229	241	292
D	-	-	-	10	13	17.5	23	30	35

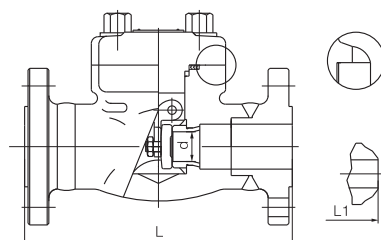

CL150-300-600

Bolted bonnet, reducing port
Flange- or butt-welded ends; design to BS5352

(NPS)	R.P	1/4	3/8	1/2	3/4	1	1 1/4	1 1/2	2
L(RF) L1(BW)	-	-	-	108	118	127	140	165	203
	-	-	-	153	178	203	216	229	267
	-	-	-	165	191	216	229	241	292
D	-	-	-	10.5	13.5	18	24	29	36.5

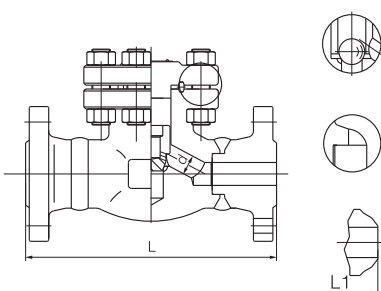

CL150-300-600

Bolted bonnet, reducing port
Flange- or butt-welded ends; design to BS5352

(NPS)	R.P	1/4	3/8	1/2	3/4	1	1 1/4	1 1/2	2
L(RF) L1(BW)	-	-	-	108	118	127	140	165	203
	-	-	-	153	178	203	216	229	267
	-	-	-	165	191	216	229	241	292
D	-	-	-	10	13	17.5	23	30	35

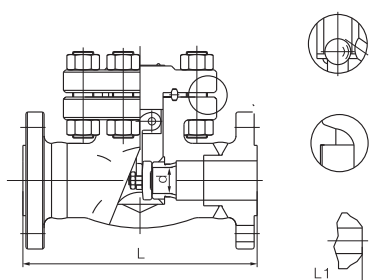

CL150-300-600

Bolted bonnet, reducing port
Flange- or butt-welded ends; design to Bs5352

(NPS)	R.P	1/4	3/8	1/2	3/4	1	1 1/4	1 1/2	2
L(RF) L1(BW)	-	-	-	108	118	127	140	165	203
	-	-	-	153	178	203	216	229	267
	-	-	-	165	191	216	229	241	292
D	-	-	-	10.5	13.5	18	24	29	36.5

Flange and Butt-Welded Check Valve CL900-2500

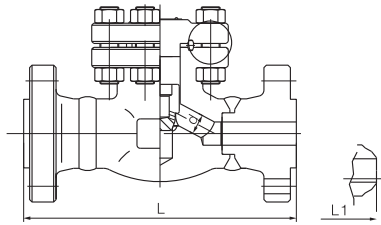

CL900-CL1500

Bolted bonnet, full port
Flange-or butt-welded ends; design to BS5352

NPS	F.P	1/2	3/4	1	1 1/4	1 1/2	2
L(RF)、L1(BW)		216	229	254	280	305	371
D	Lift	12	15	20	28	32	40
	swing	13.5	18	24	29	36.5	45

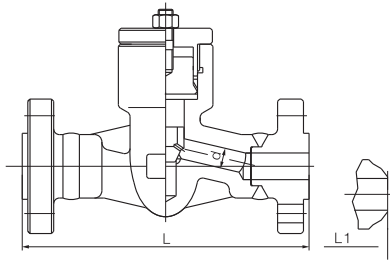

CL900-CL1500

Pressure seal, bolted bonnet, full port and reducing port
Flange-or butt-welded ends; design to BS5352

NPS	F.P	3/8	1/2	3/4	1	1 1/4	1 1/2	2
L(RF)、L1(BW)		-	216	229	254	280	305	268
L(RTJ)		-	216	229	254	280	305	371
D		-	12	28	20	28	32	40

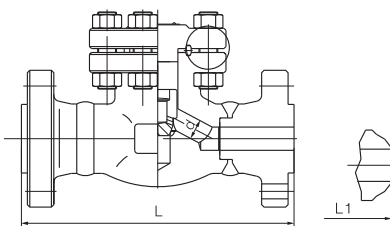

CL2500

Bolted bonnet, full port
Flange-or butt-welded ends; design to ASME B16.34

NPS	F.P	1/2	3/4	1	1 1/4	1 1/2	2
L(RF)、L1(BW)		264	273	308	349	384	450
L(RTJ)		264	273	308	352	387	454
D	Lift	12	15	20	28	32	40
	swing	10.5	13.5	18	24	29	36.5

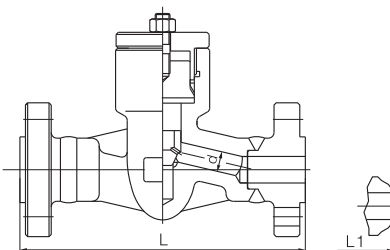

CL2500

Pressure seal, Bolted bonnet, full port
Flange-or butt-welded ends; design to ASME B16.34

NPS	F.P	3/8	1/2	3/4	1	1 1/4	1 1/2	2
L(RF)、L1(BW)		-	264	273	308	349	384	450
L(RTJ)		-	264	273	308	352	387	454
D		-	12	15	20	32	28	40

Y Type Check Valve CL800-1500

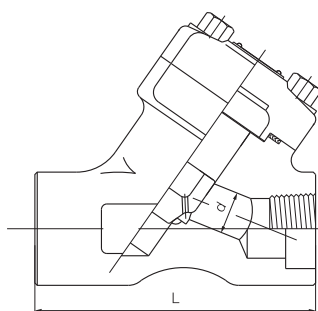

CL800

Bolted bonnet, full port and reducing port
Threaded, butt-welded or socket welded ends; design to BS5352

NPS	R.P	-	1/2	3/4	1	1 1/4	1 1/2	2	2 1/2	3
	F.P	1/4	3/8	1/2	3/4	1	1 1/4	1 1/2	2	2 1/2
L		98	98	96	111	140	140	155	170	-
D		7	10	13	17.5	23	30	35	46	-

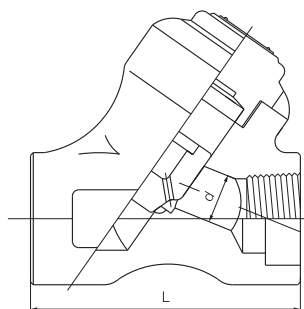

CL800

Welded bonnet, full port and reducing port
Threaded, butt-welded or socket welded ends; design to BS5352

NPS	R.P	-	1/2	3/4	1	1 1/4	1 1/2	2	2 1/2	3
	F.P	1/4	3/8	1/2	3/4	1	1 1/4	1 1/2	2	2 1/2
L		79	79	92	100	140	140	155	170	-
D		7	10	13	17.5	23	30	35	46	-

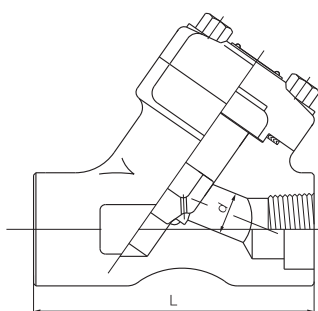

CL900-CL1500

Bolted bonnet, full port
Threaded, butt-welded or socket welded ends; design to BS5352

NPS	F.P	3/8	1/2	3/4	1	1 1/4	1 1/2	2	2 1/2
L		98	111	111	140	140	155	170	-
D		9	12	15	20	28	32	40	-

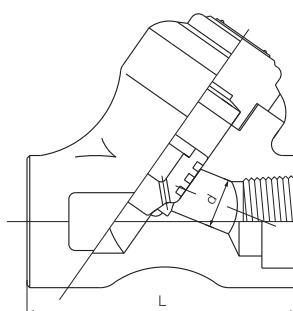

CL900-CL1500

Welded bonnet, full port
Threaded, butt-welded or socket welded ends; design to BS5352

NPS	F.P	3/8	1/2	3/4	1	1 1/4	1 1/2	2	2 1/2
L		92	100	100	140	140	155	170	-
D		9	12	15	20	32	28	40	-

Y Type Check Valve CL2500-4500

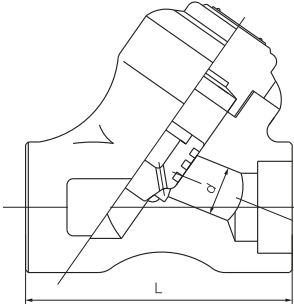

CL2500

Welded bonnet, full port
Threaded, butt-welded or socket welded ends; design to ASME B16.34

NPS	F.P	3 / 8	1 / 2	3 / 4	1	1 1/4	1 1/2	2
L		186	186	186	186	232	232	310
D		9	11	14	19	25	28	35

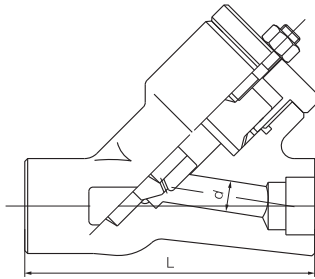

CL2500

Pressure seal, bolted bonnet, full port
Threaded, butt-welded or socket welded ends; design to ASME B16.34

NPS	F.P	3 / 8	1 / 2	3 / 4	1	1 1/4	1 1/2	2
L		186	186	186	186	232	232	310
D		9	11	14	19	25	28	35

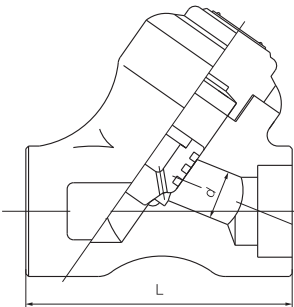

CL4500

Welded bonnet, full port
Threaded, butt-welded or socket welded ends; design to ASME B16.34

NPS	F.P	3 / 8	1 / 2	3 / 4	1	1 1/4	1 1/2	2
L		156	155	155	155		225	225
D		9	11	11	15		26	28

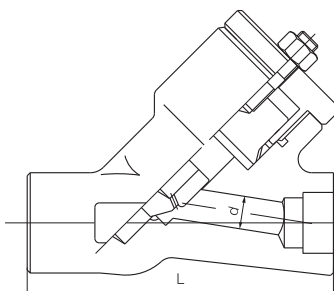

CL4500

Pressure seal, bolted bonnet, full port
Threaded, butt-welded or socket welded ends; design to ASME B16.34

NPS	F.P	3 / 8	1 / 2	3 / 4	1	1 1/4	1 1/2	2
L		200	200	200	200	250	250	330
D		9	11	11	15	20	26	28